

Grout Areas with Masonry Walls Insulated with Icon Inserts

8 Inch Units

Volume = (255.3 in.³)

1 cu yd = 46,656 in.³

Approx 182 8-inch Blocks with Icon Inserts can be grouted with 1 cu yd.

10 Inch Units

Volume = (383.5 in.³)

1 cu yd = 46,656 in.³

Approx 121 10-inch Blocks with Icon Inserts can be grouted with 1 cu yd.

12 Inch Units

Volume = (556.0 in.³)

1 cu yd = 46,656 inches³

Approx 83 12-inch Blocks with Icon Inserts can be grouted with 1 cu yd.

Paul Grycel 
Director of Engineering
9 May 2014

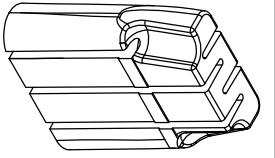

15 5/8

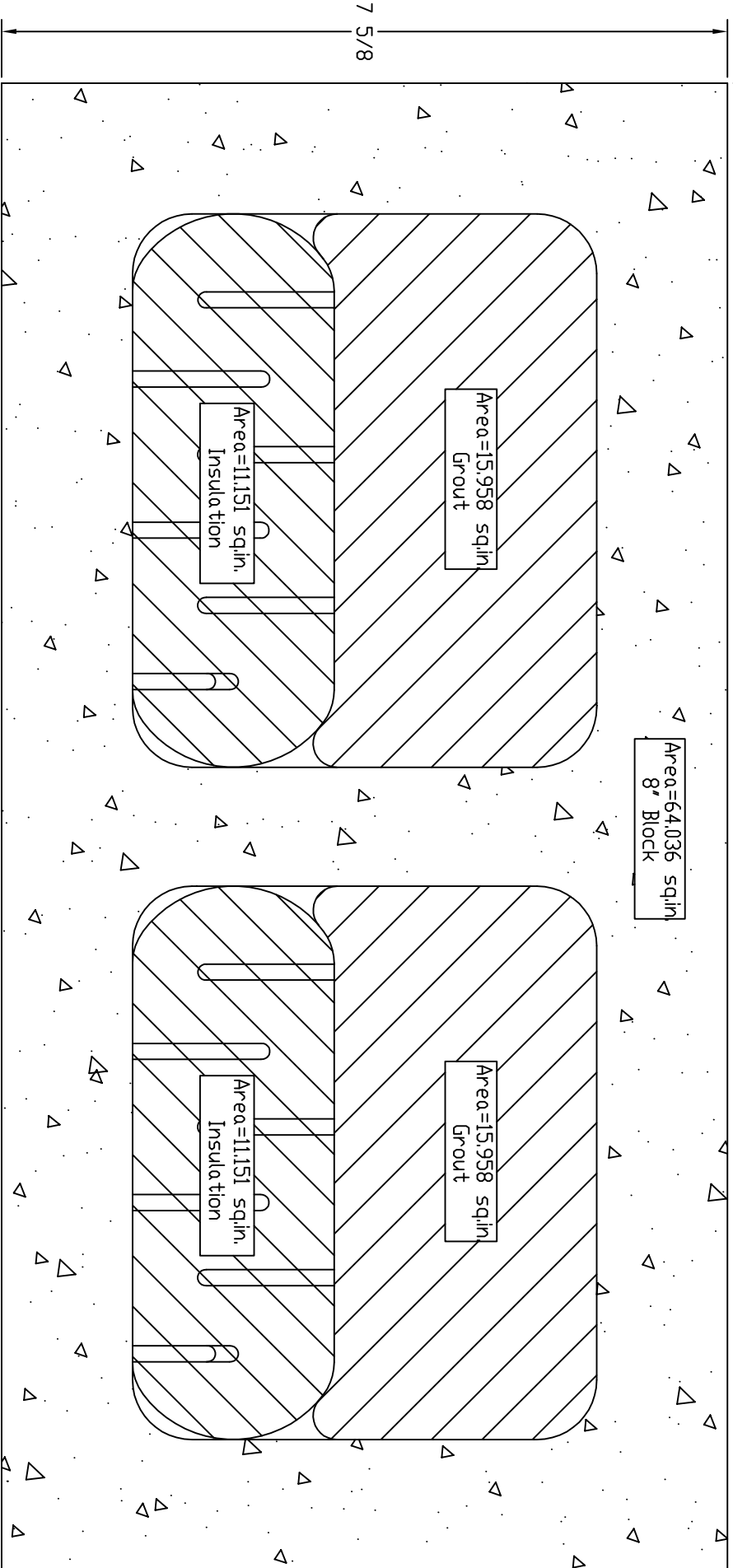

NOTE:

1. 8" Block Dimensions per NCMA Standards
2. View Shown at Half High Level
3. Korfil ICON Insulation Shown

CBIS/KORFIL

P.O. BOX 1000
FREIGHT HOUSE ROAD
WEST BROOKFIELD, MA. 01585
WWW.CBISINC.COM



GRYCEL
5/7/2010

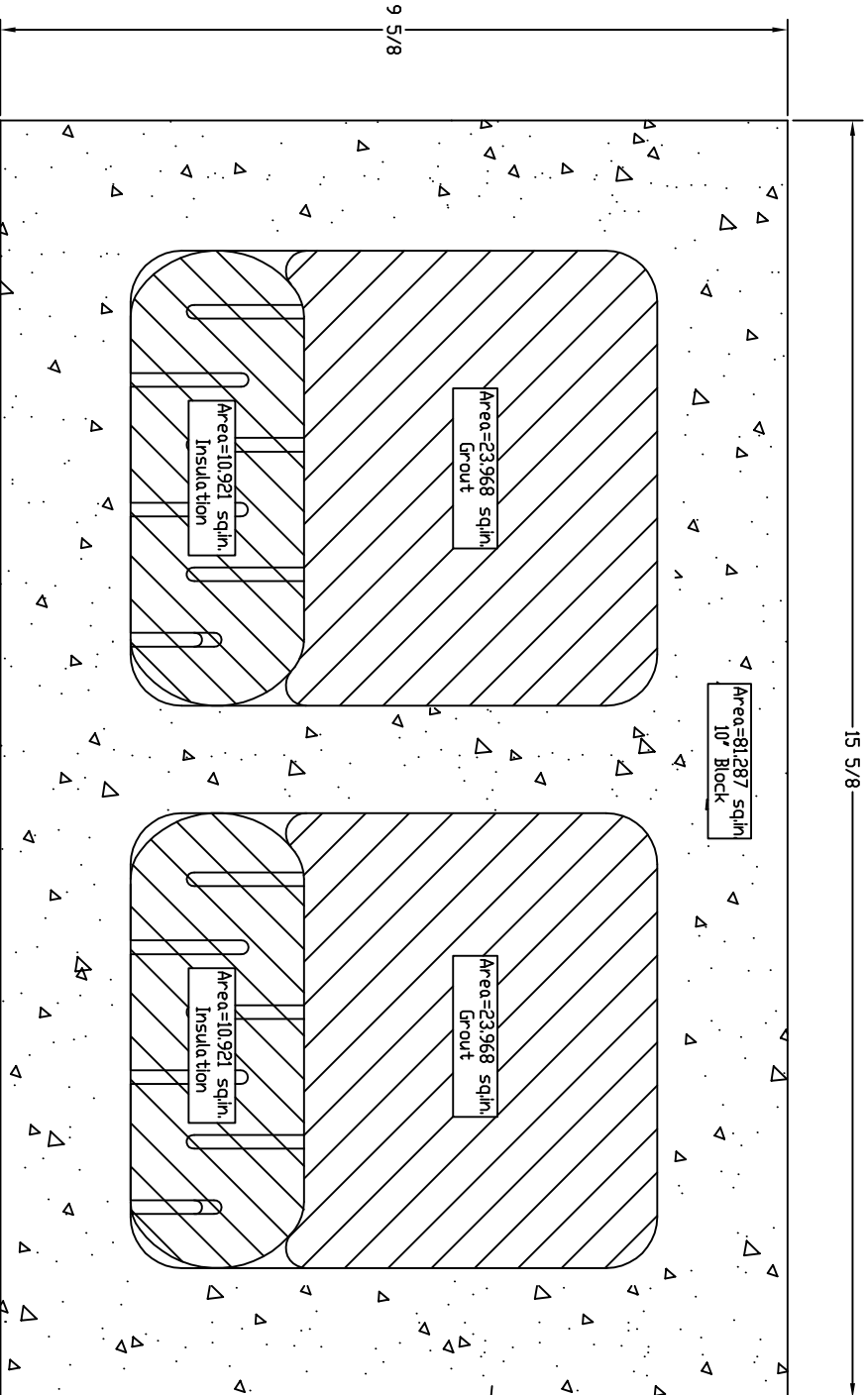
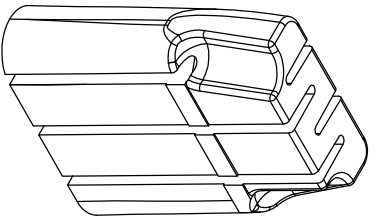

- NOTE:**
1. 10" Block Dimensions per NCMA Standards
 2. View Shown at Half High Level
 3. Korfil ICON Insulation Shown

CBIS/KORFIL

P.O. BOX 1000
FREIGHT HOUSE ROAD
WEST BROOKFIELD, MA. 01585
WWW.CBISINC.COM



GRYCEL
5/7/2010

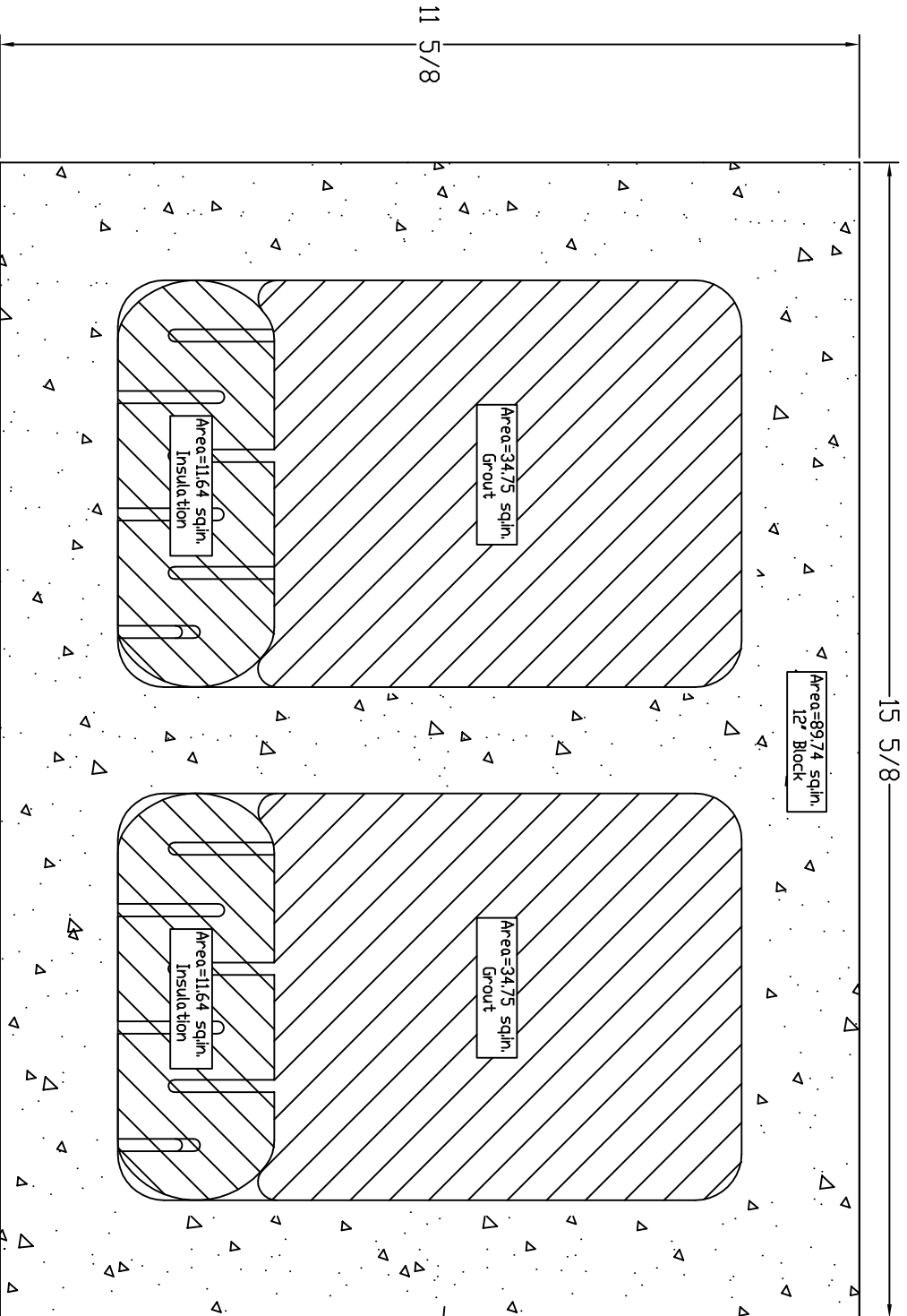
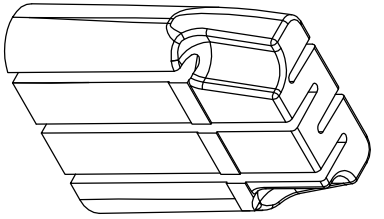

- NOTE:**
1. 12" Block Dimensions per NCMA Standards
 2. View Shown at Half High Level
 3. Korfil ICON Insulation Shown

CBIS/KORFIL
 P.O. BOX 1000
 FREIGHT HOUSE ROAD
 WEST BROOKFIELD, MA. 01585
 WWW.CBISINC.COM



GRYCEL
 5/7/2010