

15 5/8

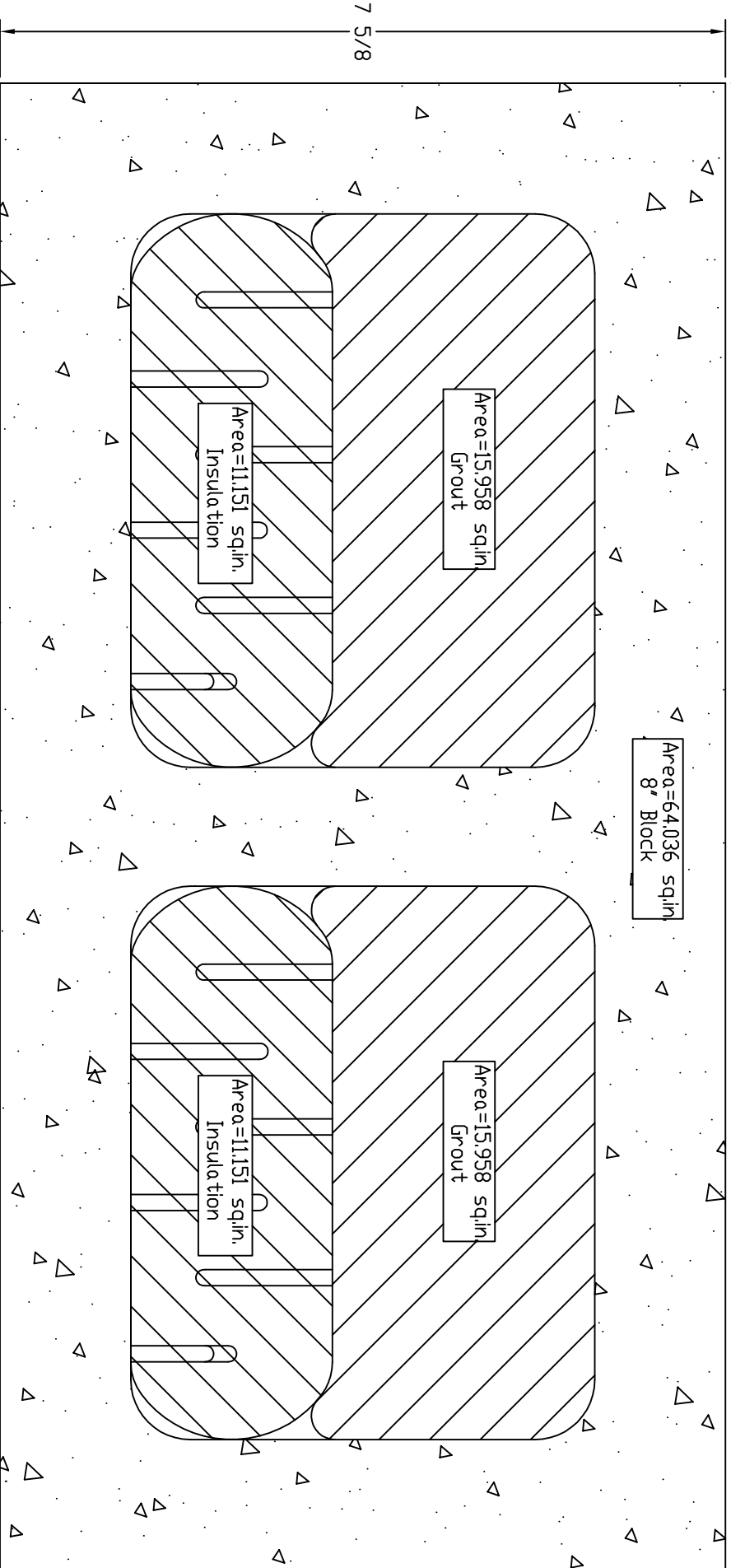

- NOTE:**
1. 8" Block Dimensions per NCMA Standards
 2. View Shown at Half High Level
 3. Korfil ICON Insulation Shown

CBIS/KORFIL

P.O. BOX 1000
FREIGHT HOUSE ROAD
WEST BROOKFIELD, MA. 01585
WWW.CBISINC.COM



GRYCEL
5/7/2010

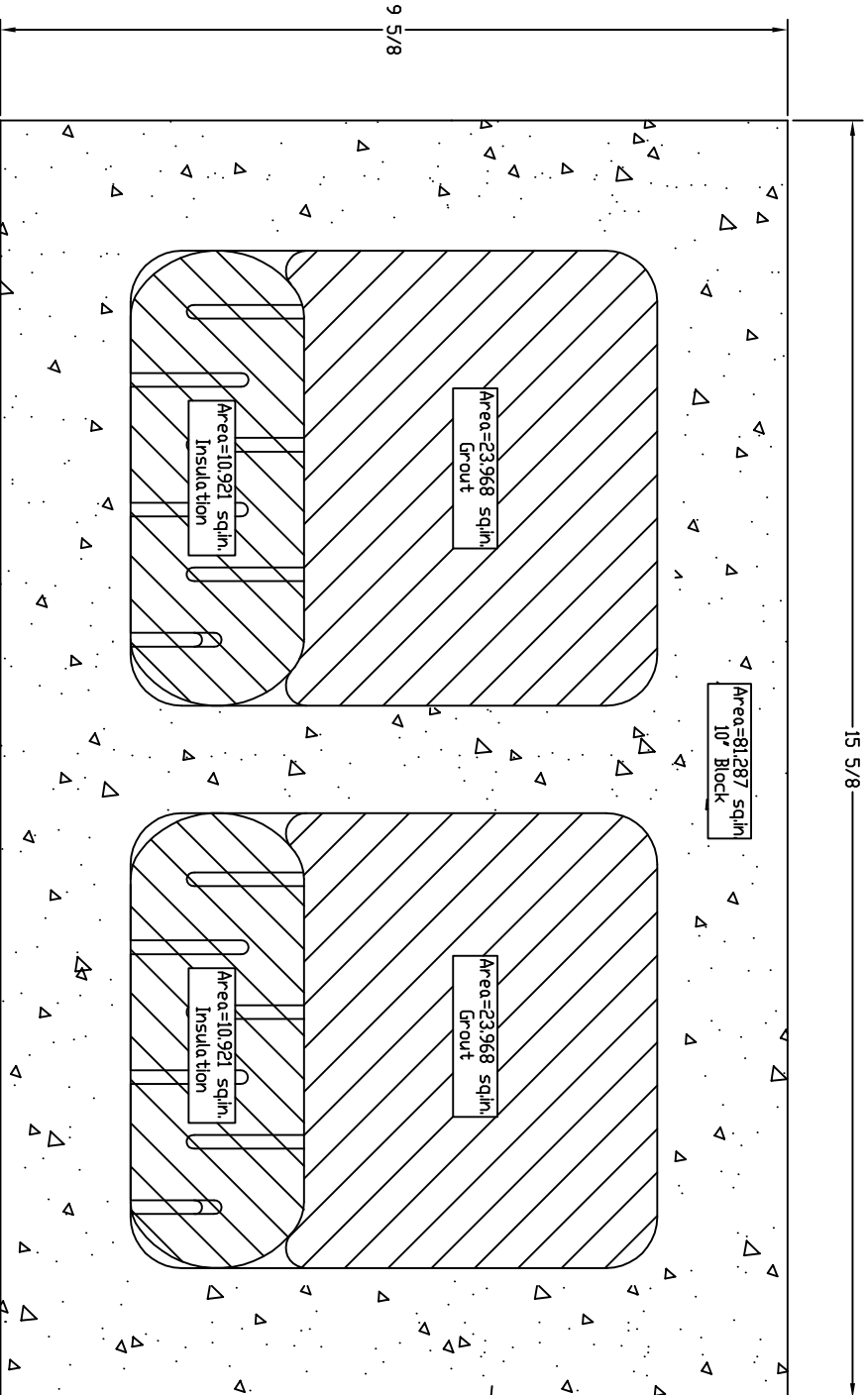
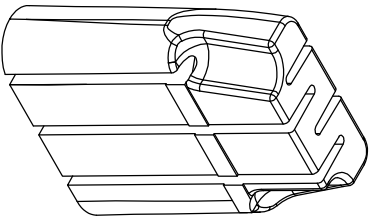

- NOTE:**
1. 10" Block Dimensions per NCMA Standards
 2. View Shown at Half High Level
 3. Korfil ICON Insulation Shown

CBIS/KORFIL

P.O. BOX 1000
FREIGHT HOUSE ROAD
WEST BROOKFIELD, MA. 01585
WWW.CBISINC.COM



GRYCEL
5/7/2010

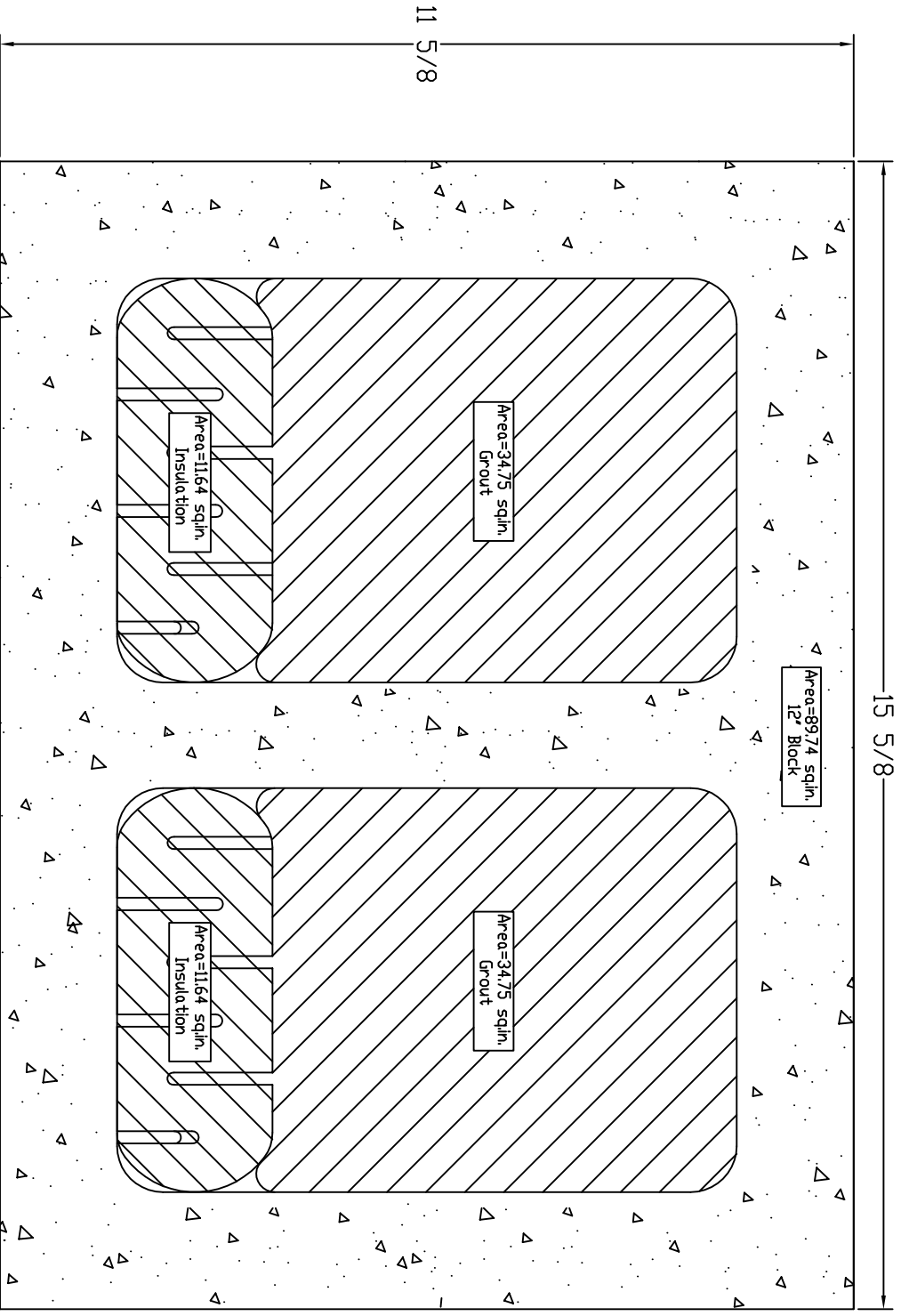
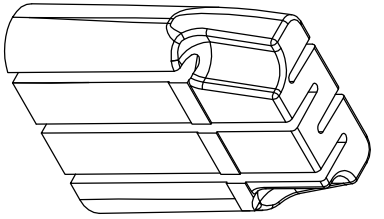

- NOTE:**
1. 12" Block Dimensions per NCMA Standards
 2. View Shown at Half High Level
 3. Korfil ICON Insulation Shown

CBIS/KORFIL
 P.O. BOX 1000
 FREIGHT HOUSE ROAD
 WEST BROOKFIELD, MA. 01585
 WWW.CBISINC.COM



GRYCEL
 5/7/2010